

**680 & 5680**

These industrial supply grilles feature adjustable, single deflection, extruded aluminum airfoil blades with a steel or extruded aluminum frame. Horizontal or vertical blades at 1 1/4", 2", or 3" spacing available.

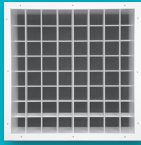

**6880 & 56880**

These industrial supply grilles feature adjustable, double deflection, extruded aluminum airfoil blades with a steel or extruded aluminum frame. Horizontal or vertical front blades at 1 1/4", 2", or 3" spacing available.



**680MP & 5680MP**

These industrial supply grilles feature fully adjustable extruded aluminum front blades with pole operated rear blades, with a steel or extruded aluminum frame. Horizontal or vertical front blades at 3/4" spacing.



**DPL**

This industrial supply drum louver features extruded aluminum, rear hinged vanes, aluminum frame, and up to 60° of rotation.

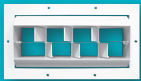

**DPL2**

This industrial supply drum louver features extruded aluminum, rear hinged, split vanes, an aluminum frame, and up to 60° of rotation.

**680, 5680, 6880, 56880, 680MP, 5680MP**

Introduction ..... M1-3  
 Dimensional Data..... M1-4  
 Reference Charts..... M1-8  
 Performance Data..... M1-11  
 Engineering Specifications..... M1-23

**DPL, DPL2**

Introduction & Dimensional Data ..... M1-25  
 Pattern Selection & Detail..... M1-26  
 Heavy Duty Damper (Model DOBHD) ..... M1-27  
 Reference Charts..... M1-28  
 Performance Data..... M1-30  
 Engineering Specification ..... M1-34

## Introduction: DPL, DPL2

The DPL/DPL2 series drum louvers deliver air with extremely long throws, which makes them ideally suited for installation in large enclosures. Controlling length of the throw and direction is made possible by rotating the adjustable drum and louver vanes. The DPL2 offers a split vane for added control of airflow. The drum rotation features 60° angular adjustment of the jet centerline (30° up from centerline to 30° down). Combining these two features together, the DPL and DPL2 facilitate complete air coverage in the occupied area. Drum louvers may be mounted in either a horizontal or vertical position without affecting the distribution of air from the outlet, which offers architects and engineers unlimited application possibilities without location restrictions. As an added benefit, the long throws reduce costly branch ducting often required when other types of air outlets are employed.

### MODELS

DPL - Drum Louver

DPL2 - Drum Louver with Split Vanes

### FEATURES

- Extruded aluminum, rear hinged blades and aluminum frame construction.
- Up to 60° of rotation.

DPL



DPL2

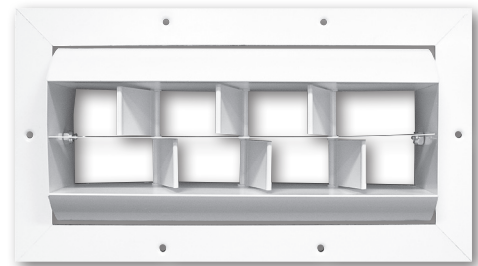

### ACCESSORY

- Heavy Duty Damper (Model DOBHD)

### FINISHES

- Standard finish is #44 British White.
- Optional finish is Mill.  
(Grille/damper shares common finish.)

## Face View, Cross Section, & Rotation Details: DPL

### DPL, DPL2, FACE VIEW \*

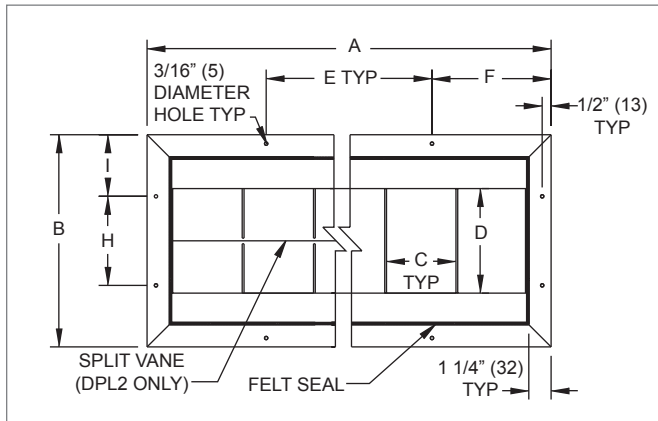

### DPL, CROSS SECTION \*

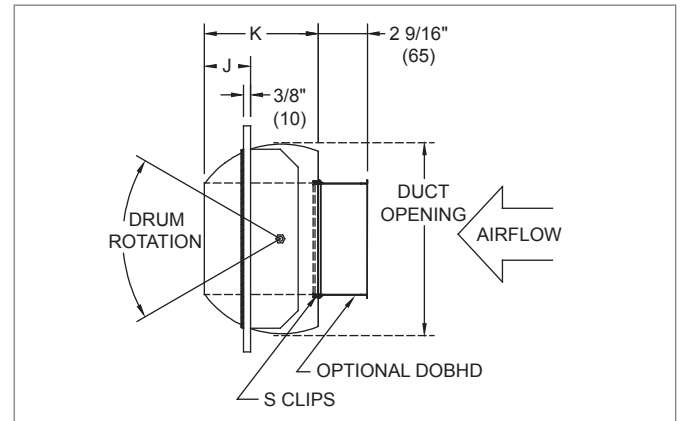

### DPL, DPL2, ROTATION DESCRIPTION

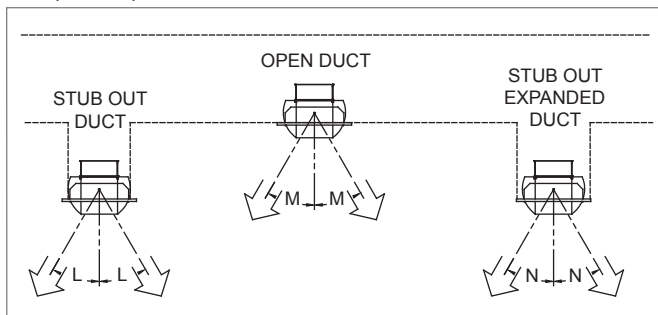

### DPL, DPL2, ROTATION DETAIL

DPL Width	DPL with DOBHD			DPL without DOBHD		
	L	M	N	L	M	N
6" (152)	28°	30°	30°	30°	30°	30°
10" (254)	30°	30°	30°	30°	30°	30°
12" (305)	25°	25°	25°	25°	25°	25°
15" (381)	27°	27°	27°	27°	27°	27°

NOTES: Dimensions in parentheses are mm.

\* See chart on next page for dimensional references.

**DPL, DPL2 Pattern Selection & Detail**

**DPL, DPL2, PATTERN SELECTIONS**

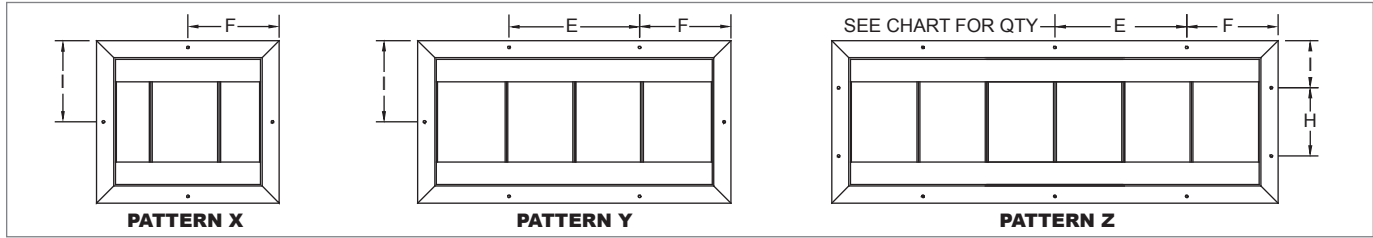

**DPL, DPL2, PATTERN DIMENSIONAL DETAIL**

Nominal Size	Duct Opening	A	B	C	D	E	F	H	I	J	K	Vanes	Pattern	Screw Qty
6" x 9" (152 x 229)	6 5/8" x 10 1/8" (168 x 257)	11 11/16" (297)	8 3/16" (208)	3" (76)	3 5/16" (84)	6" (152)	5 27/32" (148)	-	4 3/32" (104)	1 21/32" (42)	3 5/8" (92)	2 2	X X	4 4
6" x 12" (152 x 305)	6 5/8" x 13 1/8" (168 x 333)	14 11/16" (373)	8 3/16" (208)	3" (76)	3 5/16" (84)	6" (152)	4 27/32" (123)	-	4 3/32" (104)	1 21/32" (42)	3 5/8" (92)	3 3	Y Y	6 6
6" x 18" (152 x 457)	6 5/8" x 19 1/8" (168 x 486)	20 11/16" (525)	8 3/16" (208)	3" (76)	3 5/16" (84)	6" (152)	5 11/32" (136)	-	4 3/32" (104)	1 21/32" (42)	3 5/8" (92)	5 5	Z Z	8 8
6" x 24" (152 x 610)	6 5/8" x 25 1/8" (168 x 638)	26 11/16" (678)	8 3/16" (208)	3" (76)	3 5/16" (84)	6" (152)	5 27/32" (148)	-	4 3/32" (104)	1 21/32" (42)	3 5/8" (92)	7 7	Z Z	10 10
6" x 30" (152 x 762)	6 5/8" x 31 1/8" (168 x 791)	32 11/16" (830)	8 3/16" (208)	3" (76)	3 5/16" (84)	6" (152)	6 11/32" (161)	-	4 3/32" (104)	1 21/32" (42)	3 5/8" (92)	9 9	Z Z	12 12
6" x 36" (152 x 914)	6 5/8" x 37 1/8" (168 x 943)	38 11/16" (983)	8 3/16" (208)	3" (76)	3 5/16" (84)	6" (152)	6 27/32" (174)	-	4 3/32" (104)	1 21/32" (42)	3 5/8" (92)	11 11	Z Z	14 14
6" x 48" (152 x 1219)	6 5/8" x 49 1/8" (168 x 1248)	50 11/16" (1287)	8 3/16" (208)	3" (76)	3 5/16" (84)	6" (152)	5 11/32" (136)	-	4 3/32" (104)	1 21/32" (42)	3 5/8" (92)	15 15	Z Z	20 20
6" x 60" (152 x 1524)	6 5/8" x 61 1/8" (168 x 1553)	62 11/16" (1592)	8 3/16" (208)	3" (76)	3 5/16" (84)	6" (152)	6 11/32" (161)	-	4 3/32" (104)	1 21/32" (42)	3 5/8" (92)	19 19	Z Z	24 24
10" x 20" (254 x 508)	10 3/8" x 21 1/8" (264 x 537)	22 11/16" (576)	11 15/16" (303)	5" (127)	5 7/8" (149)	5" (127)	6 11/32" (161)	(127)	3 15/32" (88)	2 7/16" (62)	6" (152)	3 3	Z Z	10 10
10" x 25" (254 x 635)	10 3/8" x 26 1/8" (264 x 664)	27 11/16" (703)	11 15/16" (303)	5" (127)	5 7/8" (149)	5" (127)	6 11/32" (161)	(127)	3 15/32" (88)	2 7/16" (62)	6" (152)	4 4	Z Z	12 12
10" x 30" (254 x 762)	10 3/8" x 31 1/8" (264 x 791)	32 11/16" (830)	11 15/16" (303)	5" (127)	5 7/8" (149)	5" (127)	6 11/32" (161)	(127)	3 15/32" (88)	2 7/16" (62)	6" (152)	5 5	Z Z	14 14
10" x 35" (254 x 889)	10 3/8" x 36 1/8" (264 x 918)	37 11/16" (957)	11 15/16" (303)	5" (127)	5 7/8" (149)	5" (127)	6 11/32" (161)	(127)	3 15/32" (88)	2 7/16" (62)	6" (152)	6 6	Z Z	16 16
10" x 40" (254 x 1016)	10 3/8" x 41 1/8" (264 x 1045)	42 11/16" (1084)	11 15/16" (303)	5" (127)	5 7/8" (149)	5" (127)	6 11/32" (161)	(127)	3 15/32" (88)	2 7/16" (62)	6" (152)	7 7	Z Z	18 18
10" x 50" (254 x 1270)	10 3/8" x 51 1/8" (264 x 1299)	52 11/16" (1338)	11 15/16" (303)	5" (127)	5 7/8" (149)	5" (127)	6 11/32" (161)	(127)	3 15/32" (88)	2 7/16" (62)	6" (152)	9 9	Z Z	22 22
10" x 60" (254 x 1524)	10 3/8" x 61 1/8" (264 x 1553)	62 11/16" (1592)	11 15/16" (303)	5" (127)	5 7/8" (149)	5" (127)	6 11/32" (161)	(127)	3 15/32" (88)	2 7/16" (62)	6" (152)	11 11	Z Z	26 26
10" x 70" (254 x 1778)	10 3/8" x 71 1/8" (264 x 1807)	72 11/16" (1846)	11 15/16" (303)	5" (127)	5 7/8" (149)	5" (127)	6 11/32" (161)	(127)	3 15/32" (88)	2 7/16" (62)	6" (152)	13 13	Z Z	30 30
12" x 20" (305 x 508)	12 3/8" x 21 1/8" (314 x 537)	22 11/16" (576)	13 15/16" (354)	5" (127)	6 7/8" (175)	5" (127)	6 11/32" (161)	(152)	3 31/32" (101)	3" (76)	6" (152)	3 3	Z Z	10 10
12" x 30" (305 x 762)	12 3/8" x 31 1/8" (314 x 791)	32 11/16" (830)	13 15/16" (354)	5" (127)	6 7/8" (175)	5" (127)	6 11/32" (161)	(152)	3 31/32" (101)	3" (76)	6" (152)	5 5	Z Z	14 14
12" x 40" (305 x 1016)	12 3/8" x 41 1/8" (314 x 1045)	42 11/16" (1084)	13 15/16" (354)	5" (127)	6 7/8" (175)	5" (127)	6 11/32" (161)	(152)	3 31/32" (101)	3" (76)	6" (152)	7 7	Z Z	18 18
12" x 50" (305 x 1270)	12 3/8" x 51 1/8" (314 x 1299)	52 11/16" (1338)	13 15/16" (354)	5" (127)	6 7/8" (175)	5" (127)	6 11/32" (161)	(152)	3 31/32" (101)	3" (76)	6" (152)	9 9	Z Z	22 22
12" x 60" (305 x 1524)	12 3/8" x 61 1/8" (314 x 1553)	62 11/16" (1592)	13 15/16" (354)	5" (127)	6 7/8" (175)	5" (127)	6 11/32" (161)	(152)	3 31/32" (101)	3" (76)	6" (152)	11 11	Z Z	26 26
12" x 70" (305 x 1778)	12 3/8" x 71 1/8" (314 x 1807)	72 11/16" (1846)	13 15/16" (354)	5" (127)	6 7/8" (175)	5" (127)	6 11/32" (161)	(152)	3 31/32" (101)	3" (76)	6" (152)	13 13	Z Z	30 30
15" x 15" (381 x 381)	15 3/8" x 16 1/8" (391 x 410)	17 11/16" (449)	17" (432)	5" (127)	9 7/8" (251)	5" (127)	6 11/32" (161)	9" (229)	4" (102)	3 3/16" (81)	8 1/8" (206)	2 2	Z Z	8 8
15" x 20" (381 x 508)	15 3/8" x 21 1/8" (391 x 537)	22 11/16" (576)	17" (432)	5" (127)	9 7/8" (251)	5" (127)	6 11/32" (161)	9" (229)	4" (102)	3 3/16" (81)	8 1/8" (206)	3 3	Z Z	10 10
15" x 25" (381 x 635)	15 3/8" x 26 1/8" (391 x 664)	27 11/16" (703)	17" (432)	5" (127)	9 7/8" (251)	5" (127)	6 11/32" (161)	9" (229)	4" (102)	3 3/16" (81)	8 1/8" (206)	4 4	Z Z	12 12
15" x 30" (381 x 762)	15 3/8" x 31 1/8" (391 x 791)	32 11/16" (830)	17" (432)	5" (127)	9 7/8" (251)	5" (127)	6 11/32" (161)	9" (229)	4" (102)	3 3/16" (81)	8 1/8" (206)	5 5	Z Z	14 14
15" x 40" (381 x 1016)	15 3/8" x 41 1/8" (391 x 1045)	42 11/16" (1084)	17" (432)	5" (127)	9 7/8" (251)	5" (127)	6 11/32" (161)	9" (229)	4" (102)	3 3/16" (81)	8 1/8" (206)	7 7	Z Z	18 18
15" x 50" (381 x 1270)	15 3/8" x 51 1/8" (391 x 1299)	52 11/16" (1338)	17" (432)	5" (127)	9 7/8" (251)	5" (127)	6 11/32" (161)	9" (229)	4" (102)	3 3/16" (81)	8 1/8" (206)	9 9	Z Z	22 22
15" x 60" (381 x 1524)	15 3/8" x 61 1/8" (391 x 1553)	62 11/16" (1592)	17" (432)	5" (127)	9 7/8" (251)	5" (127)	6 11/32" (161)	9" (229)	4" (102)	3 3/16" (81)	8 1/8" (206)	11 11	Z Z	26 26
15" x 70" (381 x 1778)	15 3/8" x 71 1/8" (391 x 1807)	72 11/16" (1846)	17" (432)	5" (127)	9 7/8" (251)	5" (127)	6 11/32" (161)	9" (229)	4" (102)	3 3/16" (81)	8 1/8" (206)	13 13	Z Z	30 30

NOTES: Dimensions in parentheses are mm. See drawings on previous page for additional dimensional references.

**DOBHD (Heavy Duty Damper) Dimensional Information**

**DOBHD, FACE VIEW**

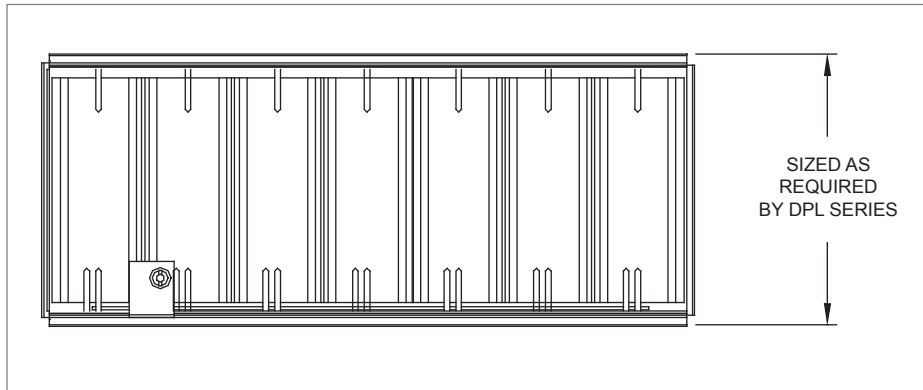

**DOBHD, CROSS SECTION**

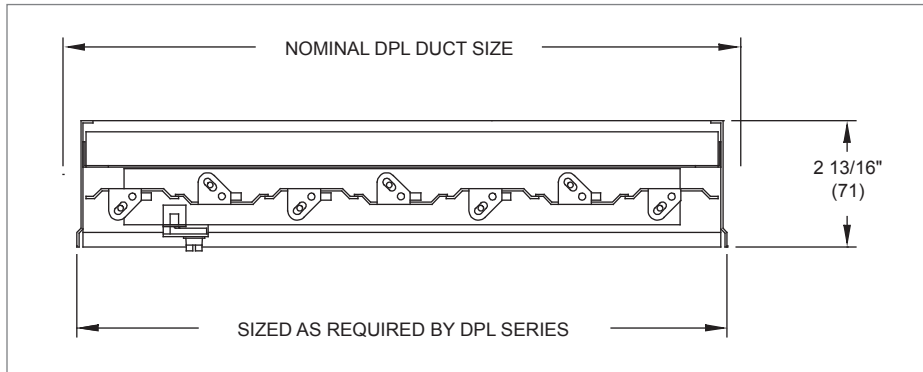

**DOBHD, SIDE VIEW**

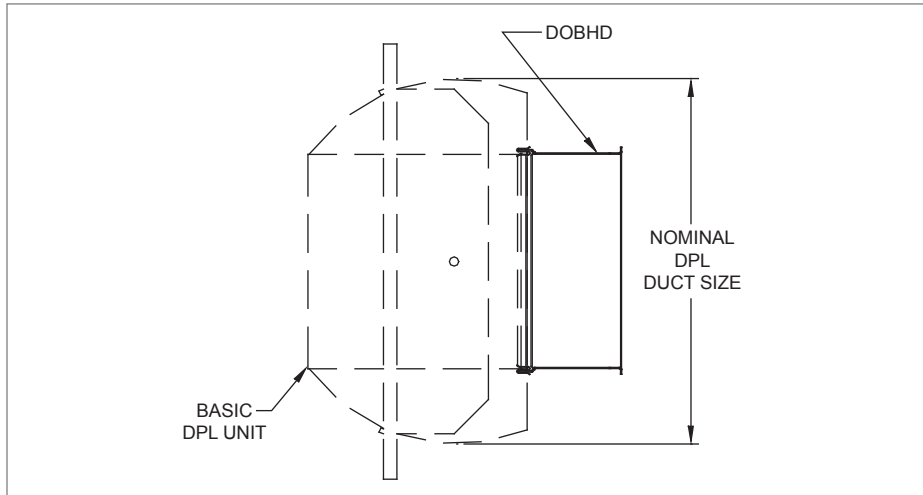

NOTE: Dimensions in parentheses are mm.

**DPL, DPL2 Reference Charts**

**AIRFLOW VS. NC LEVEL: DPL, DPL2, 6" HEIGHT (NO DOBHD)**

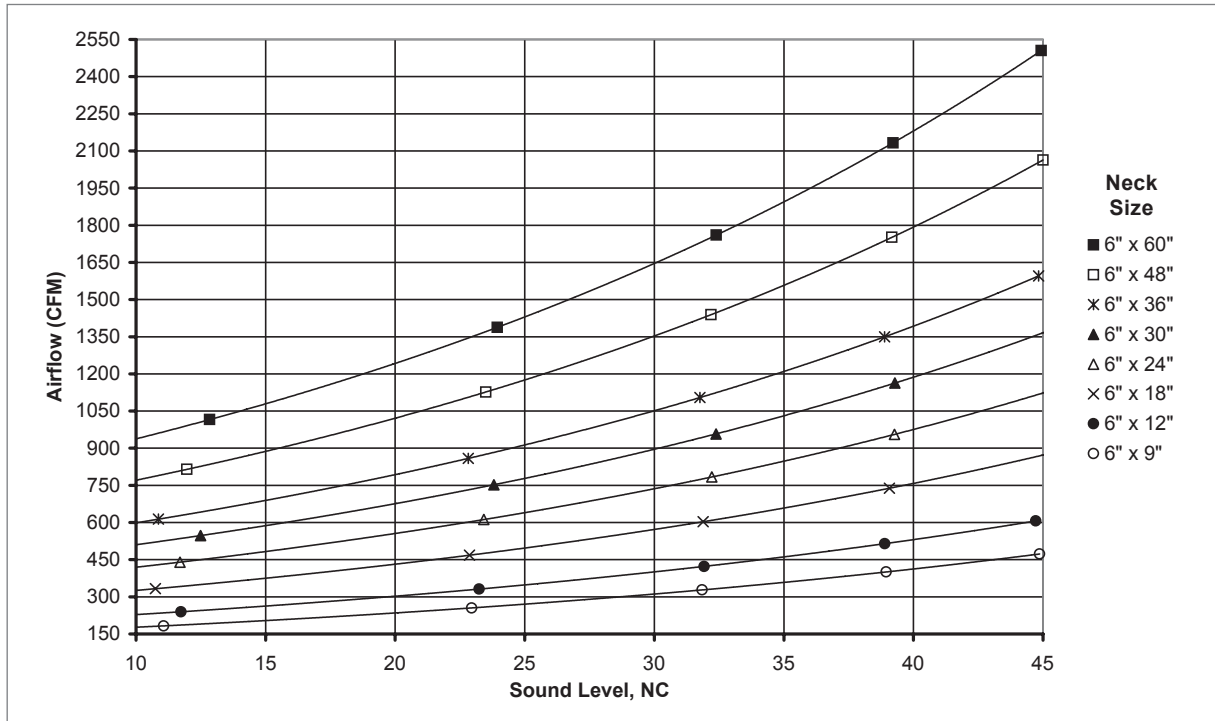

**AIRFLOW VS. NC LEVEL: DPL, DPL2, 10" HEIGHT (NO DOBHD)**

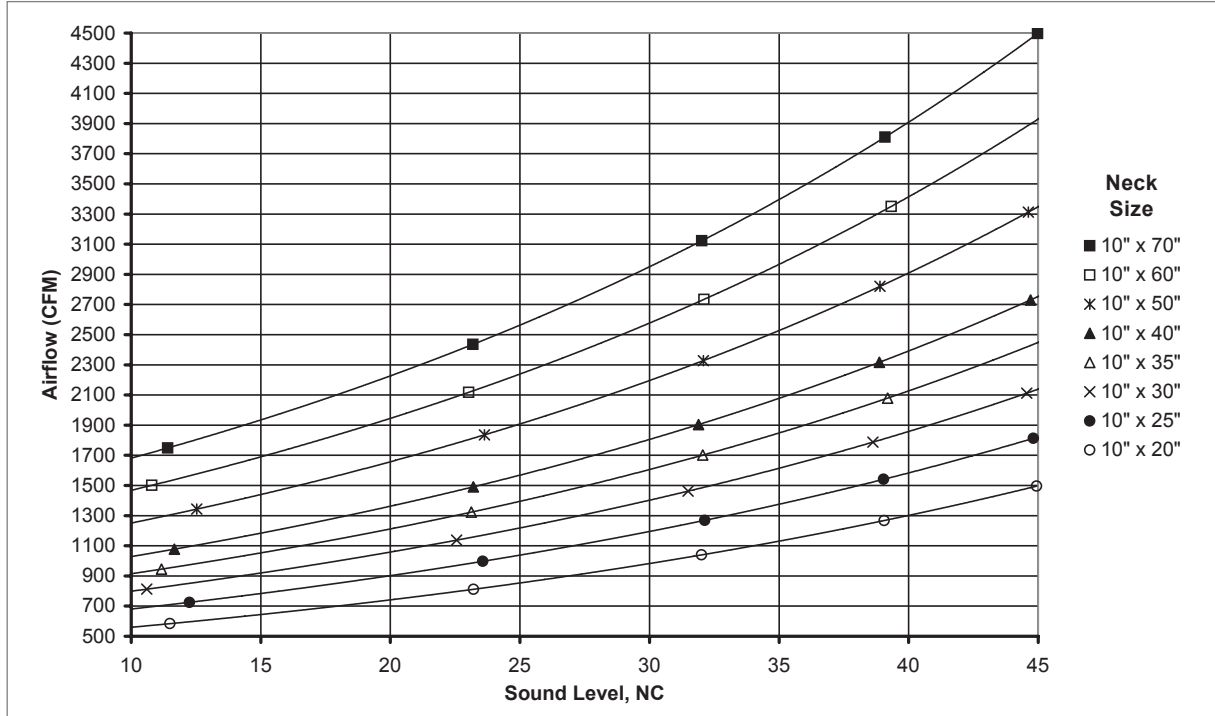

INDUSTRIAL GRILLES

DPL - DPL2

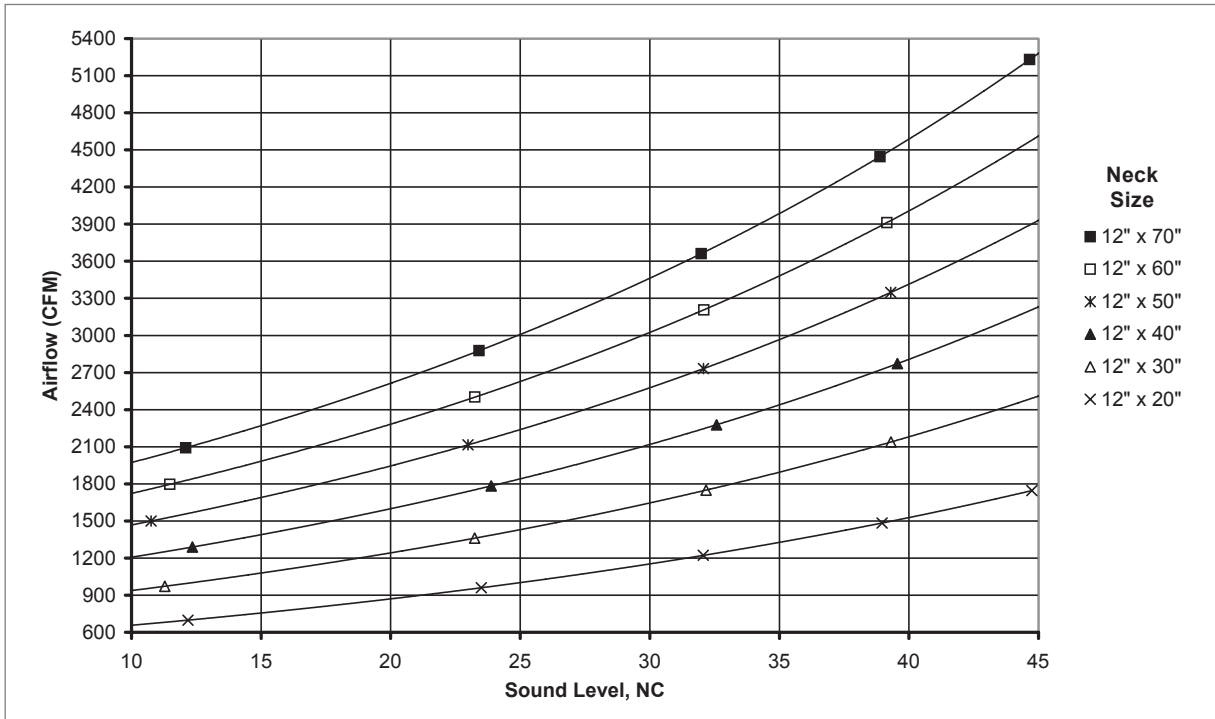
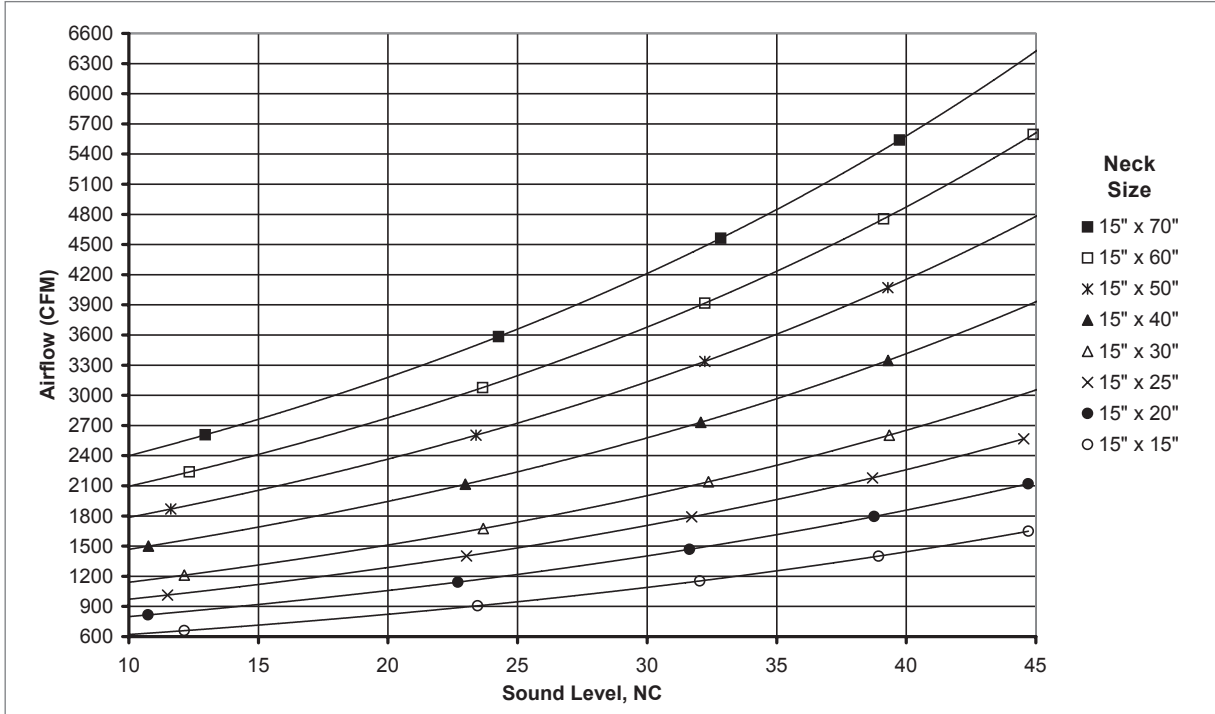
**DPL, DPL2 Reference Charts**
**AIRFLOW VS. NC LEVEL: DPL, DPL2, 12" HEIGHT (NO DOBHD)**

**AIRFLOW VS. NC LEVEL: DPL, DPL2, 15" HEIGHT (NO DOBHD)**

**DPL, DPL2 Performance Data: Horizontal Throw**

IP/METRIC DATA: DPL, DPL2, 6" HEIGHT (NO DOBHD)

Listed Size	IP Data				NC	Metric Size	Metric Data				Octave Band, dB						
	Duct Vel	Air Flow	Pt	Throw			Duct Vel	Air Flow	Pt	Throw	2	3	4	5	6	7	
	in.	FPM	CFM	"WG			ft	mm	m/s	L/s	Pa	m					
6" x 9"	425	183	.092	6 - 12 - 24	11	152	2.16	86	22.8	1.7 - 3.8 - 7.4	32	29	28	23	18	-	
	594	255	.179	11 - 20 - 29	23		3.02	120	44.5	3.3 - 6.2 - 8.8	41	38	38	35	31	19	
	763	328	.295	18 - 23 - 33	32		3.87	155	73.4	5.4 - 7.0 - 9.9	49	46	45	43	41	30	
	931	400	.440	21 - 25 - 36	39		4.73	189	109.4	6.3 - 7.7 - 11.0	54	51	51	50	50	38	
	1100	473	.613	23 - 28 - 39	45		5.59	223	152.7	6.9 - 8.4 - 11.9	59	56	56	56	56	45	
6" x 12"	425	240	.092	9 - 20 - 28	12	152	2.16	113	22.8	2.9 - 6.0 - 8.5	33	30	29	23	18	-	
	588	331	.175	18 - 23 - 33	23		2.98	156	43.6	5.5 - 7.0 - 10.0	42	39	38	35	31	19	
	750	423	.285	21 - 26 - 37	32		3.81	200	71.0	6.5 - 8.0 - 11.3	49	46	45	43	41	29	
	913	515	.422	24 - 29 - 41	39		4.64	243	105.1	7.2 - 8.8 - 12.4	54	51	51	50	49	38	
	1075	606	.586	26 - 31 - 44	45		5.46	286	145.8	7.8 - 9.5 - 13.5	59	56	56	56	56	45	
6" x 18"	400	333	.081	18 - 23 - 33	11	152	2.03	157	20.2	5.6 - 7.1 - 10.0	33	30	28	22	17	-	
	563	468	.160	23 - 28 - 39	23		2.86	221	39.9	6.8 - 8.4 - 11.8	42	39	38	34	31	18	
	725	603	.266	26 - 31 - 44	32		3.68	285	66.3	7.8 - 9.5 - 13.5	49	46	46	43	41	29	
	888	738	.399	28 - 35 - 49	39		4.51	348	99.4	8.6 - 10.5 - 14.9	55	52	52	51	49	38	
	1050	874	.559	31 - 38 - 53	45		5.33	412	139.1	9.3 - 11.4 - 16.2	60	57	57	56	56	45	
6" x 24"	400	440	.081	22 - 27 - 38	12	152	2.03	208	20.2	6.6 - 8.1 - 11.5	34	31	29	23	18	-	
	556	612	.157	26 - 32 - 45	23		2.83	289	39.0	7.8 - 9.6 - 13.5	43	40	39	35	31	19	
	713	784	.257	29 - 36 - 50	32		3.62	370	64.1	8.9 - 10.8 - 15.3	50	47	46	44	41	29	
	869	956	.382	32 - 39 - 56	39		4.41	451	95.2	9.8 - 12.0 - 16.9	55	52	52	51	49	38	
	1025	1128	.532	35 - 43 - 60	45		5.21	532	132.6	10.6 - 13.0 - 18.4	60	57	57	57	56	45	
6" x 30"	400	547	.081	24 - 30 - 42	12	152	2.03	258	20.2	7.4 - 9.1 - 12.8	34	31	30	24	18	-	
	550	752	.153	29 - 35 - 49	24		2.79	355	38.2	8.7 - 10.6 - 15.0	43	40	39	35	31	19	
	700	958	.248	32 - 39 - 56	32		3.56	452	61.8	9.8 - 12.0 - 16.9	50	47	46	44	41	29	
	850	1163	.366	35 - 43 - 61	39		4.32	549	91.2	10.8 - 13.2 - 18.7	55	52	52	51	49	37	
	1000	1368	.507	38 - 47 - 67	45		5.08	646	126.2	11.7 - 14.3 - 20.3	60	57	57	56	56	44	
6" x 36"	375	614	.071	26 - 32 - 45	11	152	1.91	290	17.7	7.8 - 9.6 - 13.6	33	30	29	23	16	-	
	525	859	.140	30 - 37 - 53	23		2.67	405	34.8	9.3 - 11.4 - 16.1	43	40	39	34	30	18	
	675	1104	.231	35 - 42 - 60	32		3.43	521	57.5	10.5 - 12.9 - 18.2	50	47	46	43	40	28	
	825	1350	.345	38 - 47 - 66	39		4.19	637	85.9	11.6 - 14.2 - 20.1	55	52	52	50	49	37	
	975	1595	.482	42 - 51 - 72	45		4.95	753	120.0	12.6 - 15.5 - 21.9	60	57	57	56	56	44	
6" x 48"	375	815	.071	30 - 36 - 51	12	152	1.91	384	17.7	9.0 - 11.1 - 15.6	34	31	30	24	18	-	
	519	1127	.136	35 - 43 - 60	23		2.64	532	34.0	10.6 - 13.0 - 18.4	43	40	39	35	31	18	
	663	1439	.222	39 - 48 - 68	32		3.37	679	55.4	12.0 - 14.7 - 20.8	50	47	47	44	41	29	
	806	1751	.329	44 - 53 - 75	39		4.10	826	82.0	13.2 - 16.2 - 22.9	56	53	52	51	49	37	
	950	2063	.457	47 - 58 - 82	45		4.83	974	113.9	14.4 - 17.6 - 24.9	60	57	57	56	56	44	
6" x 60"	375	1016	.071	33 - 41 - 57	13	152	1.91	479	17.7	10.1 - 12.3 - 17.5	35	32	31	25	18	-	
	513	1388	.133	39 - 47 - 67	24		2.60	655	33.1	11.8 - 14.4 - 20.4	44	41	40	36	31	19	
	650	1760	.214	44 - 53 - 76	32		3.30	831	53.3	13.3 - 16.2 - 23.0	51	48	47	44	41	29	
	788	2133	.314	48 - 59 - 83	39		4.00	1006	78.3	14.6 - 17.9 - 25.3	56	53	53	51	49	37	
	925	2505	.434	52 - 64 - 90	45		4.70	1182	108.0	15.8 - 19.4 - 27.4	61	58	57	56	55	44	

NOTES: Throw values are given for terminal velocities of 150, 100, and 50 FPM (0.75, 0.50, and 0.25 m/s). Throw values are given for isothermal conditions. NC values are based on octave band 2 - 7 sound power levels minus a room absorption of 10dB, re 10<sup>-12</sup> Watts. Sound is based on a 0° spread; for 20° spread, add 4 NC; for 40° spread, add 9 NC. Throw is based on a 15° upward deflection; for 0° deflection, multiply throws by 1.2; for 30° deflection, multiply by 0.8. Dash in space denotes a NC or dB value of less than 10. Data was obtained from tests conducted in accordance with ANSI/ASHRAE Standard 70, ISO Standard 5219, and ISO Standard 3741. See Krueger's selection program for performance data not shown, including octave band data.

INDUSTRIAL GRILLES

D  
P  
L  
-  
D  
P  
L  
2



**DPL, DPL2 Performance Data: Horizontal Throw**

IP/METRIC DATA: DPL, DPL2, 10" HEIGHT (NO DOBHD)

Listed Size	IP Data					NC	Metric Size	Metric Data				Octave Band, dB						
	Duct Vel	Air Flow	Pt	Throw	Duct Vel			Air Flow	Pt	Throw	2	3	4	5	6	7		
	in. FPM	CFM	"WG	ft	mm			m/s	L/s	Pa	m							
10" x 20"	400	584	.055	25 - 31 - 44	11	254 x 508	2.03	275	13.6	7.6 - 9.4 - 13.2	34	31	29	23	17	-		
	556	812	.105	30 - 36 - 51	23		2.83	383	26.3	9.0 - 11.0 - 15.6	43	40	39	35	31	18		
	713	1040	.173	34 - 41 - 58	32		3.62	491	43.1	10.2 - 12.5 - 17.7	50	47	46	44	41	29		
	869	1268	.257	37 - 45 - 64	39		4.41	598	64.0	11.3 - 13.8 - 19.5	55	52	52	51	49	37		
	1025	1496	.358	40 - 49 - 70	45		5.21	706	89.2	12.2 - 15.0 - 21.2	60	57	57	56	56	44		
10" x 25"	400	725	.055	28 - 34 - 49	12	254 x 635	2.03	342	13.6	8.5 - 10.4 - 14.7	34	31	30	24	18	-		
	550	997	.103	33 - 40 - 57	24		2.79	471	25.7	10.0 - 12.2 - 17.3	43	40	39	35	31	18		
	700	1269	.167	37 - 45 - 64	32		3.56	599	41.6	11.3 - 13.8 - 19.5	50	47	47	44	41	29		
	850	1541	.246	41 - 50 - 71	39		4.32	727	61.3	12.4 - 15.2 - 21.5	56	53	52	51	49	37		
	1000	1813	.341	44 - 54 - 77	45		5.08	856	84.9	13.5 - 16.5 - 23.3	60	57	57	56	55	44		
10" x 30"	375	812	.048	30 - 36 - 51	11	254 x 762	1.91	383	11.9	9.0 - 11.0 - 15.6	33	30	29	22	16	-		
	525	1137	.094	35 - 43 - 61	23		2.67	537	23.4	10.7 - 13.1 - 18.5	43	40	39	34	30	17		
	675	1462	.155	40 - 49 - 69	31		3.43	690	38.7	12.1 - 14.8 - 20.9	50	47	46	43	40	28		
	825	1787	.232	44 - 54 - 76	39		4.19	844	57.8	13.4 - 16.4 - 23.2	55	52	52	50	48	36		
	975	2112	.324	48 - 59 - 83	45		4.95	997	80.7	14.5 - 17.8 - 25.2	60	57	57	56	55	43		
10" x 35"	375	945	.048	32 - 39 - 55	11	254 x 889	1.91	446	11.9	9.7 - 11.9 - 16.8	34	31	29	23	16	-		
	525	1323	.094	38 - 46 - 66	23		2.67	624	23.4	11.5 - 14.1 - 19.9	43	40	39	35	30	18		
	675	1701	.155	43 - 53 - 74	32		3.43	803	38.7	13.0 - 16.0 - 22.6	50	47	47	44	41	28		
	825	2079	.232	47 - 58 - 82	39		4.19	981	57.8	14.4 - 17.7 - 25.0	56	53	53	51	49	37		
	975	2457	.324	52 - 63 - 89	45		4.95	1160	80.7	15.7 - 19.2 - 27.2	61	58	58	57	56	44		
10" x 40"	375	1078	.048	34 - 42 - 59	12	254 x 1016	1.91	509	11.9	10.4 - 12.7 - 18.0	34	31	30	23	17	-		
	519	1491	.092	40 - 49 - 70	23		2.64	704	22.8	12.2 - 15.0 - 21.1	44	41	39	35	30	18		
	663	1904	.150	45 - 56 - 79	32		3.37	899	37.2	13.8 - 16.9 - 23.9	50	47	47	43	40	28		
	806	2317	.222	50 - 61 - 87	39		4.10	1094	55.2	15.2 - 18.6 - 26.4	56	53	52	50	48	36		
	950	2730	.308	54 - 67 - 94	45		4.83	1289	76.6	16.5 - 20.2 - 28.6	60	57	57	56	55	43		
10" x 50"	375	1343	.048	38 - 47 - 66	13	254 x 1270	1.91	634	11.9	11.6 - 14.2 - 20.1	35	32	31	24	18	-		
	513	1836	.090	45 - 55 - 77	24		2.60	866	22.3	13.5 - 16.6 - 23.5	44	41	40	35	31	18		
	650	2328	.144	50 - 61 - 87	32		3.30	1099	35.9	15.3 - 18.7 - 26.4	51	48	47	44	40	28		
	788	2820	.211	55 - 68 - 96	39		4.00	1331	52.6	16.8 - 20.6 - 29.1	56	53	53	50	48	36		
	925	3313	.292	60 - 73 - 104	45		4.70	1564	72.6	18.2 - 22.3 - 31.5	61	58	57	56	55	43		
10" x 60"	350	1501	.042	40 - 49 - 70	11	254 x 1524	1.78	708	10.4	12.3 - 15.0 - 21.2	34	31	30	23	16	-		
	494	2118	.083	48 - 59 - 83	23		2.51	999	20.7	14.6 - 17.8 - 25.2	44	41	40	35	30	17		
	638	2734	.139	54 - 67 - 94	32		3.24	1290	34.5	16.5 - 20.3 - 28.6	51	48	47	44	40	28		
	781	3351	.208	60 - 74 - 104	39		3.97	1581	51.8	18.3 - 22.4 - 31.7	57	54	53	51	49	36		
	925	3967	.292	66 - 80 - 113	45		4.70	1872	72.6	19.9 - 24.4 - 34.5	61	58	58	57	55	44		
10" x 70"	350	1749	.042	43 - 53 - 75	11	254 x 1778	1.78	825	10.4	13.2 - 16.2 - 22.9	35	32	30	23	16	-		
	488	2436	.081	51 - 63 - 89	23		2.48	1150	20.2	15.6 - 19.1 - 27.0	44	41	40	35	30	17		
	625	3123	.133	58 - 71 - 101	32		3.18	1474	33.2	17.7 - 21.6 - 30.6	51	48	47	44	40	28		
	763	3810	.198	64 - 79 - 111	39		3.87	1798	49.3	19.5 - 23.9 - 33.8	57	54	53	51	48	36		
	900	4497	.276	70 - 85 - 121	45		4.57	2122	68.7	21.2 - 26.0 - 36.7	61	58	58	56	55	43		

NOTES: Throw values are given for terminal velocities of 150, 100, and 50 FPM (0.75, 0.50, and 0.25 m/s). Throw values are given for isothermal conditions. NC values are based on octave band 2 - 7 sound power levels minus a room absorption of 10dB, re 10<sup>-12</sup> Watts. Sound is based on a 0° spread; for 20° spread, add 4 NC; for 40° spread, add 9 NC. Throw is based on a 15° upward deflection; for 0° deflection, multiply throws by 1.2; for 30° deflection, multiply by 0.8. Dash in space denotes a NC or dB value of less than 10. Data was obtained from tests conducted in accordance with ANSI/ASHRAE Standard 70, ISO Standard 5219, and ISO Standard 3741. See Krueger's selection program for performance data not shown, including octave band data.



**DPL, DPL2 Performance Data: Horizontal Throw**

IP/METRIC DATA: DPL, DPL2, 12" HEIGHT (NO DOBHD)

Listed Size	IP Data				NC	Metric Size	Metric Data				Octave Band, dB						
	Duct Vel	Air Flow	Pt	Throw			Duct Vel	Air Flow	Pt	Throw	2	3	4	5	6	7	
	in.	FPM	CFM	"WG ft			mm	m/s	L/s	Pa	m						
12" x 20"	400	698	.051	27 - 34 - 48	12	305	2.03	330	12.7	8.4 - 10.2 - 14.5	34	31	30	24	18	-	
	550	960	.096	32 - 39 - 56	23		2.79	453	24.0	9.8 - 12.0 - 17.0	43	40	39	35	31	18	
	700	1222	.156	36 - 45 - 63	32		3.56	577	38.9	11.1 - 13.5 - 19.1	50	47	46	44	41	29	
	850	1484	.230	40 - 49 - 69	39		4.32	700	57.3	12.2 - 14.9 - 21.1	55	52	52	50	49	37	
	1000	1746	.319	43 - 53 - 75	45		5.08	824	79.4	13.2 - 16.2 - 22.9	60	57	57	56	55	44	
12" x 30"	375	972	.045	32 - 40 - 56	11	305	1.91	459	11.2	9.9 - 12.1 - 17.1	34	31	30	23	17	-	
	525	1361	.088	38 - 47 - 66	23		2.67	642	21.9	11.7 - 14.3 - 20.2	43	40	39	35	30	18	
	675	1750	.145	44 - 53 - 75	32		3.43	826	36.2	13.2 - 16.2 - 22.9	51	48	47	44	41	28	
	825	2138	.217	48 - 59 - 83	39		4.19	1009	54.0	14.6 - 17.9 - 25.3	56	53	53	51	49	37	
	975	2527	.303	52 - 64 - 91	45		4.95	1193	75.4	15.9 - 19.5 - 27.5	61	58	58	57	56	44	
12" x 40"	375	1289	.045	37 - 46 - 65	12	305	1.91	609	11.2	11.4 - 13.9 - 19.7	35	32	31	24	18	-	
	519	1784	.086	44 - 54 - 76	24		2.64	842	21.4	13.4 - 16.4 - 23.1	44	41	40	36	31	18	
	663	2278	.140	50 - 61 - 86	33		3.37	1075	34.8	15.1 - 18.5 - 26.1	51	48	47	44	41	29	
	806	2772	.207	55 - 67 - 95	40		4.10	1308	51.6	16.6 - 20.4 - 28.8	57	54	53	51	49	37	
	950	3266	.288	59 - 73 - 103	45		4.83	1542	71.6	18.1 - 22.1 - 31.3	61	58	58	57	56	44	
12" x 50"	350	1500	.039	40 - 49 - 70	11	305	1.78	708	9.7	12.2 - 15.0 - 21.2	34	31	30	23	16	-	
	494	2116	.078	48 - 59 - 83	23		2.51	998	19.3	14.5 - 17.8 - 25.2	44	41	40	35	30	17	
	638	2731	.130	54 - 67 - 94	32		3.24	1289	32.3	16.5 - 20.2 - 28.6	51	48	47	44	40	28	
	781	3347	.195	60 - 74 - 104	39		3.97	1580	48.4	18.3 - 22.4 - 31.7	57	54	53	51	48	36	
	925	3963	.273	65 - 80 - 113	45		4.70	1870	67.9	19.9 - 24.4 - 34.5	61	58	58	57	55	44	
12" x 60"	350	1796	.039	44 - 54 - 76	11	305	1.78	848	9.7	13.4 - 16.4 - 23.2	35	32	30	23	16	-	
	488	2501	.076	52 - 64 - 90	23		2.48	1181	18.9	15.8 - 19.4 - 27.4	44	41	40	35	30	17	
	625	3207	.125	59 - 72 - 102	32		3.18	1513	31.0	17.9 - 21.9 - 31.0	51	48	47	44	40	28	
	763	3912	.185	65 - 80 - 113	39		3.87	1846	46.1	19.8 - 24.2 - 34.3	57	54	53	51	48	36	
	900	4618	.258	71 - 87 - 122	45		4.57	2179	64.3	21.5 - 26.3 - 37.2	61	58	58	57	55	43	
12" x 70"	350	2092	.039	48 - 58 - 82	12	305	1.78	987	9.7	14.5 - 17.7 - 25.1	35	32	31	24	17	-	
	481	2877	.074	56 - 68 - 97	23		2.44	1358	18.4	17.0 - 20.8 - 29.4	44	41	40	35	30	17	
	613	3661	.120	63 - 77 - 109	32		3.11	1728	29.8	19.1 - 23.4 - 33.1	51	48	47	44	40	27	
	744	4446	.176	69 - 85 - 120	39		3.78	2098	43.9	21.1 - 25.8 - 36.5	57	54	53	50	48	36	
	875	5230	.244	75 - 92 - 130	45		4.45	2468	60.8	22.9 - 28.0 - 39.6	61	58	58	56	54	43	

NOTES: Throw values are given for terminal velocities of 150, 100, and 50 FPM (0.75, 0.50, and 0.25 m/s). Throw values are given for isothermal conditions. NC values are based on octave band 2 - 7 sound power levels minus a room absorption of 10dB, re 10<sup>-12</sup> Watts. Sound is based on a 0° spread; for 20° spread, add 4 NC; for 40° spread, add 9 NC. Throw is based on a 15° upward deflection; for 0° deflection, multiply throws by 1.2; for 30° deflection, multiply by 0.8. Dash in space denotes a NC or dB value of less than 10. Data was obtained from tests conducted in accordance with ANSI/ASHRAE Standard 70, ISO Standard 5219, and ISO Standard 3741. See Krueger's selection program for performance data not shown, including octave band data.

INDUSTRIAL GRILLES

D  
P  
L  
-  
D  
P  
L  
2

**DPL, DPL2 Performance Data: Horizontal Throw**
**IP/METRIC DATA: DPL, DPL2, 15" HEIGHT (NO DOBHD)**

Listed Size	IP Data					NC	Metric Size	Metric Data				Octave Band, dB						
	Duct Vel	Air Flow	Pt	Throw	Duct Vel			Air Flow	Pt	Throw	2	3	4	5	6	7		
	in.	FPM	CFM	"WG	ft			mm	m/s	L/s	Pa	m						
15" x 15"	400	659	.043	27 - 33 - 46	12	381	2.03	311	10.7	8.1 - 9.9 - 14.1	34	31	30	24	18	-		
	550	906	.081	31 - 38 - 54	23		2.79	428	20.3	9.5 - 11.7 - 16.5	43	40	39	35	31	18		
	700	1154	.132	35 - 43 - 61	32		x	3.56	544	32.8	10.7 - 13.2 - 18.6	50	47	46	44	41	29	
	850	1401	.194	39 - 48 - 67	39		381	4.32	661	48.4	11.8 - 14.5 - 20.5	55	52	52	50	49	37	
15" x 20"	1000	1648	.269	42 - 52 - 73	45	381	5.08	778	67.0	12.8 - 15.7 - 22.2	60	57	57	56	55	44		
	375	816	.038	30 - 36 - 51	11		508	1.91	385	9.4	9.0 - 11.1 - 15.6	33	30	29	23	16	-	
	525	1142	.074	35 - 43 - 61	23			2.67	539	18.5	10.7 - 13.1 - 18.5	43	40	39	34	30	17	
	675	1468	.123	40 - 49 - 69	32			3.43	693	30.5	12.1 - 14.8 - 21.0	50	47	46	43	40	28	
825	1795	.183	44 - 54 - 76	39	4.19	847		45.6	13.4 - 16.4 - 23.2	56	53	52	50	48	36			
15" x 25"	975	2121	.256	48 - 59 - 83	45	635	4.95	1001	63.7	14.6 - 17.8 - 25.2	60	57	57	56	55	43		
	375	1013	.038	33 - 41 - 57	11		381	1.91	478	9.4	10.1 - 12.3 - 17.4	34	31	30	23	17	-	
	519	1402	.072	39 - 48 - 67	23			2.64	662	18.0	11.8 - 14.5 - 20.5	43	40	39	35	30	17	
	663	1790	.118	44 - 54 - 76	32			3.37	845	29.4	13.4 - 16.4 - 23.2	50	47	46	43	40	28	
806	2179	.175	49 - 59 - 84	39	4.10	1028		43.5	14.8 - 18.1 - 25.6	56	53	52	50	48	36			
15" x 30"	950	2568	.243	53 - 65 - 91	45	762	4.83	1212	60.4	16.0 - 19.6 - 27.8	60	57	57	56	55	43		
	375	1211	.038	36 - 44 - 63	12		381	1.91	572	9.4	11.0 - 13.5 - 19.1	35	32	30	24	17	-	
	519	1676	.072	43 - 52 - 74	24			2.64	791	18.0	12.9 - 15.9 - 22.4	44	41	40	35	31	18	
	663	2140	.118	48 - 59 - 83	32			3.37	1010	29.4	14.6 - 17.9 - 25.3	51	48	47	44	41	28	
806	2604	.175	53 - 65 - 92	39	4.10	1229		43.5	16.1 - 19.8 - 27.9	56	53	53	51	49	37			
15" x 40"	950	3068	.243	58 - 71 - 100	45	1016	4.83	1448	60.4	17.5 - 21.5 - 30.3	61	58	58	57	55	44		
	350	1500	.033	40 - 49 - 70	11		381	1.78	708	8.2	12.2 - 15.0 - 21.2	34	31	30	23	16	-	
	494	2116	.066	48 - 59 - 83	23			2.51	998	16.3	14.5 - 17.8 - 25.2	44	41	40	35	30	17	
	638	2731	.109	54 - 67 - 94	32			3.24	1289	27.2	16.5 - 20.2 - 28.6	51	48	47	44	40	28	
781	3347	.164	60 - 74 - 104	39	3.97	1580		40.9	18.3 - 22.4 - 31.7	57	54	53	51	48	36			
15" x 50"	925	3963	.230	65 - 80 - 113	45	1270	4.70	1870	57.3	19.9 - 24.4 - 34.5	61	58	58	57	55	44		
	350	1869	.033	45 - 55 - 78	12		381	1.78	882	8.2	13.7 - 16.7 - 23.7	35	32	30	23	16	-	
	488	2603	.064	53 - 65 - 92	23			2.48	1228	15.9	16.1 - 19.8 - 27.9	44	41	40	35	30	17	
	625	3337	.105	60 - 74 - 104	32			3.18	1575	26.2	18.3 - 22.4 - 31.6	51	48	47	44	40	28	
763	4071	.156	66 - 81 - 115	39	3.87	1921		38.9	20.2 - 24.7 - 34.9	57	54	53	51	48	36			
15" x 60"	900	4805	.218	72 - 88 - 125	45	1524	4.57	2268	54.2	21.9 - 26.8 - 38.0	61	58	58	57	55	43		
	350	2238	.033	49 - 60 - 85	12		381	1.78	1056	8.2	15.0 - 18.3 - 25.9	36	33	31	24	17	-	
	481	3077	.062	58 - 71 - 100	24			2.44	1452	15.5	17.5 - 21.5 - 30.4	45	42	40	35	30	17	
	613	3916	.101	65 - 80 - 113	32			3.11	1848	25.1	19.8 - 24.2 - 34.3	51	48	48	44	40	28	
744	4756	.149	72 - 88 - 124	39	3.78	2244		37.0	21.8 - 26.7 - 37.8	57	54	53	51	48	36			
15" x 70"	875	5595	.206	78 - 95 - 135	45	1778	4.45	2640	51.3	23.7 - 29.0 - 41.0	61	58	58	56	55	43		
	350	2607	.033	53 - 65 - 92	13		381	1.78	1230	8.2	16.1 - 19.8 - 28.0	36	33	32	25	18	-	
	481	3585	.062	62 - 76 - 108	24			2.44	1692	15.5	18.9 - 23.2 - 32.8	45	42	41	36	31	18	
	613	4562	.101	70 - 86 - 122	33			3.11	2153	25.1	21.4 - 26.2 - 37.0	52	49	48	44	41	28	
744	5540	.149	77 - 95 - 134	40	3.78	2615		37.0	23.5 - 28.8 - 40.8	57	54	54	51	49	37			
	875	6518	.206	84 - 103 - 145	46		4.45	3076	51.3	25.5 - 31.3 - 44.2	62	59	59	57	55	43		

NOTES: Throw values are given for terminal velocities of 150, 100, and 50 FPM (0.75, 0.50, and 0.25 m/s). Throw values are given for isothermal conditions. NC values are based on octave band 2 - 7 sound power levels minus a room absorption of 10dB, re 10<sup>-12</sup> Watts. Sound is based on a 0° spread; for 20° spread, add 4 NC; for 40° spread, add 9 NC. Throw is based on a 15° upward deflection; for 0° deflection, multiply throws by 1.2; for 30° deflection, multiply by 0.8. Dash in space denotes a NC or dB value of less than 10. Data was obtained from tests conducted in accordance with ANSI/ASHRAE Standard 70, ISO Standard 5219, and ISO Standard 3741. See Krueger's selection program for performance data not shown, including octave band data.

### DPL, DPL2 Suggested Specification & Configuration

#### DPL

The industrial supply drum louver shall be a Krueger model DPL. The drum louver shall be constructed with extruded aluminum frame and corners that are mitered and reinforced with aluminum chevrons by full penetration welds. This frame shall have countersunk screw holes and form a 1 1/4" border around the drum louver. The vanes shall be a heavy gage extruded aluminum and fully adjustable. The drum shall be extruded aluminum and able to rotate a minimum of 25° up or down from the centerline of the drum louver. The drum shall be separated from the frame by utilizing felt gasketing material, which facilitates drum adjustment and minimizes vibration.

Optional heavy-duty damper shall be available made of heavy gage steel and operable from the face of the supply drum louver.

#### DPL2

The industrial supply drum louver shall be a Krueger model DPL2. The drum louver shall be constructed with extruded aluminum frame and corners that are mitered and reinforced with aluminum chevrons by full penetration welds. This frame shall have countersunk screw holes and form a 1 1/4" border around the drum louver. The vanes shall be a heavy gage extruded aluminum and fully adjustable. The DPL2 shall have a split vane that allows independent adjustment of the top and bottom blades. The drum shall be extruded aluminum and able to rotate a minimum of 25° up or down from the centerline of the drum louver. The drum shall be separated from the frame by utilizing felt gasketing material, which facilitates drum adjustment and minimizes vibration.

Optional heavy-duty damper shall be available made of heavy gage steel and operable from the face of the supply grille.

#### PERFORMANCE

The manufacturer shall provide published (printed or electronic) performance data for the diffuser. Performance data shall include 2 - 7 octave band sound power levels. The diffuser shall be tested in accordance to the data standards at the time of product introduction or ANSI/ASHRAE Standard 70.

#### FINISH

The paint finish shall be #44 British White and be an anodic acrylic paint, baked at 315°F for 30 minutes. The paint thickness shall be 0.8 – 1.0 mils, gloss at 60° per ASTM D523-89 of 50 – 85%, pencil hardness per ASTM D3363-92A of HB – H, crosshatch adhesion per ASTM D3359-83 of 4B – 5B, impact per ASTM D2794-93 of direct impact >100 in/lb and reverse impact >80 in/lb, salt spray per ASTM B117-9048 of 96 hours, humidity per ASTM D2247-92 of >500 hours and water soak per ASTM D870-92 of 250 hours.

- SERIES: (XXXX)**  
DPL - Drum Louver  
DPL2 - Drum Louver with Split Vanes
- HEIGHT: (XX)**  
6", 10", 12", or 15"
- WIDTH: (XX)**  
If 6" Height: 9", 12", 18", 24", 30", 36", 48", 60"  
If 10" Height: 20", 25", 30", 35", 40", 50", 60", 70"  
If 12" Height: 20", 30", 40", 50", 60", 70"  
If 15" Height: 15", 20", 25", 30", 40", 50", 60", 70"
- DAMPER: (XX)**  
00 - No Damper  
01 - Heavy Duty Damper (Model DOBHD)
- FINISH: (XX)**  
01 - Mill  
10 - Alumican  
35 - Black  
44 - British White

INDUSTRIAL GRILLES

D  
P  
L  
-  
D  
P  
L  
2

**SAMPLE CONFIGURATION: DPL - 12x40 - 01 - 35**